

# DNESS2-S8□ Fuse for battery and battery system Protection



## Product Description

DNESS2-S8□ Fuse for battery and battery system protection, suitable for battery system, with rated voltage of DC1500V and rated current of 100A~630A, used for short circuit protection of battery and battery system.

## Model No. and meaning

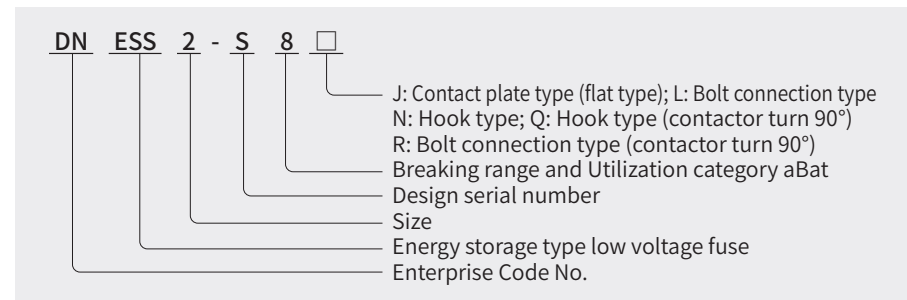

## Operational condition

1. Working humidity range: At a maximum temperature of 40°C, the relative humidity does not exceed 50%. At a maximum temperature of 20°C, the relative humidity should not exceed 90%.
2. Normal operating temperature range: -5°C to 40°C. Permissible temperature range: -40°C to 80°C.
3. Altitude: no more than 2000m. When the altitude exceeds this value:
  - 1) The temperature rise of the fuse increases by about 0.5k for every 100 meters above sea level.
  - 2) For every 100 meters of elevation increase, the ambient temperature decreases by about 0.5 °C on average.
  - 3) Under normal circumstances, fuses used in open environments can ignore the effect of altitude on rated current and still be selected in accordance with standard conditions.
  - 4) For fuses used in closed environments, if the ambient air temperature of the box or the temperature inside the box does not decrease significantly with the elevation, it can still reach more than 40°C, it is necessary to reduce the rated current capacity. Fuse rated current selection formula:

$$I = I_n \times \left(1 - \frac{h-2000}{100} \times \frac{0.5}{100}\right)$$

# DNESS2-S8J

## Fuse for battery and battery system protection



Rated Voltage	DC 1500V
Rated Current	100A, 125A, 160A, 200A, 250A, 315A, 350A, 400A, 450A, 500, 550, 630A
Utilization category	aBat
Breaking capacity	250kA
Reference Standard	IEC 60269-7

### Product parameter

Specification and model	size	Rated voltage V	Rated current A	Rated breaking capacity kA	forearc I <sup>2</sup> t kA <sup>2</sup> s	fusing I <sup>2</sup> t kA <sup>2</sup> s	In Dissipated power W
DNESS2-S8J-100	2	DC 1500V	100	250kA	1.7	8.5	53
DNESS2-S8J-125			125		3.6	17	63
DNESS2-S8J-160			160		6	30	80
DNESS2-S8J-200			200		12	52	90
DNESS2-S8J-250			250		23	105	103
DNESS2-S8J-315			315		40	210	106
DNESS2-S8J-350			350		52	273	126
DNESS2-S8J-400			400		80	309	133
DNESS2-S8J-450			450		105	345	140
DNESS2-S8J-500			500		154	493	153
DNESS2-S8J-550			550		205	878	168
DNESS2-S8J-630			630		273	1170	198

### Overall dimensions (mm)

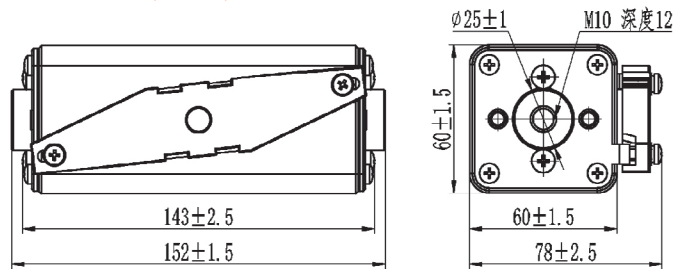

### Installation method

Bolted contact plate type (flat type)

### Time-current characteristic curve

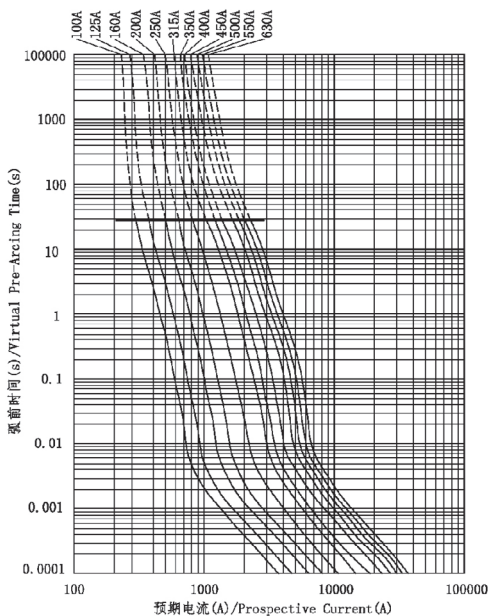

Note: The deviation range of the time current curve is  $\pm 10\%$  of the current

### Cut-off current characteristic curve

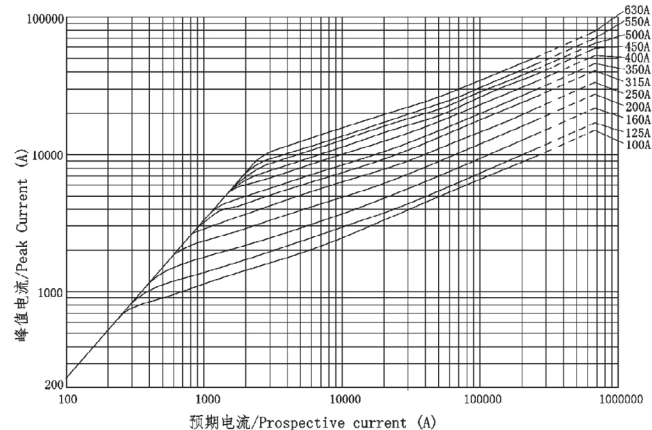

Note: The deviation range of the truncated current curve is  $\pm 10\%$  of the peak current

# DNESS2-S8L

## Fuse for battery and battery system protection



Rated Voltage	DC 1500V
Rated Current	100A, 125A, 160A, 200A, 250A, 315A, 350A, 400A, 450A, 500, 550, 630A
Protection Category	aBat
Breaking Capacity	250kA
Reference Standard	IEC 60269-7

### Product parameter

Specification and model	size	Rated voltage V	Rated current A	Rated breaking capacity kA	forearc I <sup>2</sup> t kA <sup>2</sup> s	fusing I <sup>2</sup> t kA <sup>2</sup> s	In Dissipated power W
DNESS2-S8L-100	2	DC 1500V	100	250kA	1.7	8.5	53
DNESS2-S8L-125			125		3.6	17	63
DNESS2-S8L-160			160		6	30	80
DNESS2-S8L-200			200		12	52	90
DNESS2-S8L-250			250		23	105	103
DNESS2-S8L-315			315		40	210	106
DNESS2-S8L-350			350		52	273	126
DNESS2-S8L-400			400		80	309	133
DNESS2-S8L-450			450		105	345	140
DNESS2-S8L-500			500		154	493	153
DNESS2-S8L-550			550		205	878	168
DNESS2-S8L-630			630		273	1170	198

### Overall dimensions (mm)

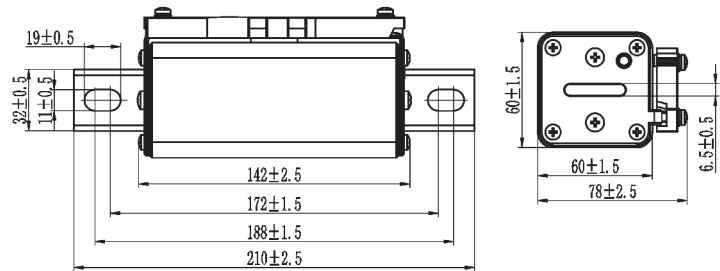

### Installation method

Bolted connection type

### Time-current characteristic curve

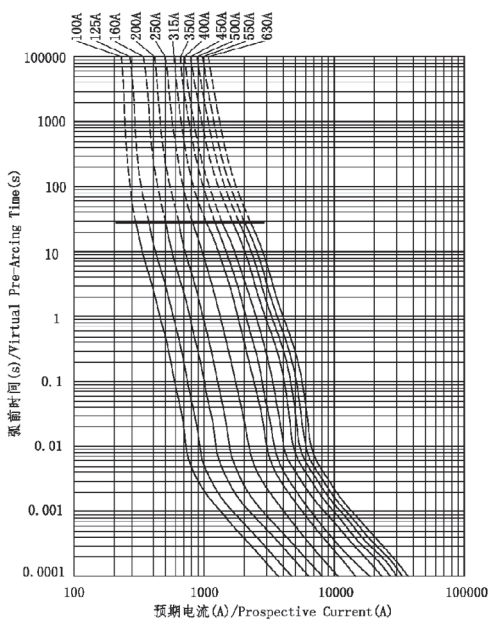

Note: The deviation range of the time current curve is  $\pm 10\%$  of the current

### Cut-off current characteristic curve

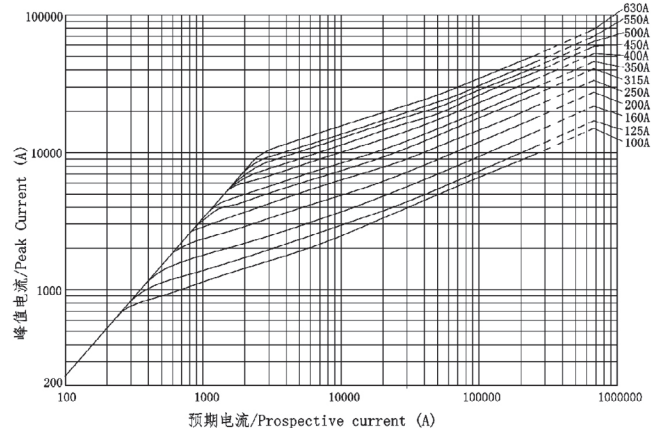

Note: The deviation range of the truncated current curve is  $\pm 10\%$  of the peak current

# DNESS2-S8N

## Fuse for battery and battery system protection



Rated Voltage	DC 1500V
Rated Current	100A, 125A, 160A, 200A, 250A, 315A, 350A, 400A, 450A, 500A, 550A, 630A
Protection Category	aBat
Breaking Capacity	DC 250kA
Reference Standard	IEC 60269-7

### Product parameter

Specification and model	size	Rated voltage V	Rated current A	Rated breaking capacity kA	forearc I <sup>2</sup> t kA <sup>2</sup> s	fusing I <sup>2</sup> t kA <sup>2</sup> s	In Dissipated power W
DNESS2-S8N-100	2	DC 1500V	100	250kA	1.7	8.5	53
DNESS2-S8N-125			125		3.6	17	63
DNESS2-S8N-160			160		6	30	80
DNESS2-S8N-200			200		12	52	90
DNESS2-S8N-250			250		23	105	103
DNESS2-S8N-315			315		40	210	106
DNESS2-S8N-350			350		52	273	126
DNESS2-S8N-400			400		80	309	133
DNESS2-S8N-450			450		105	345	140
DNESS2-S8N-500			500		154	493	153
DNESS2-S8N-550			550		205	878	168
DNESS2-S8N-630			630		273	1170	198

### Overall dimensions (mm)

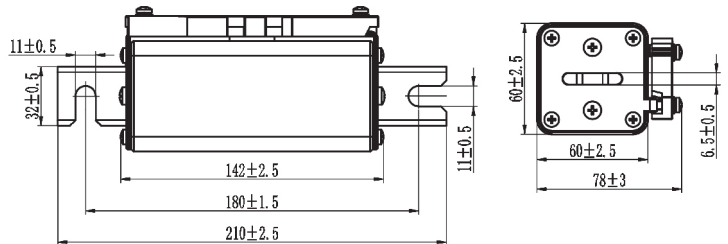

### Installation method

Bolt-on hook type

### Time-current characteristic curve

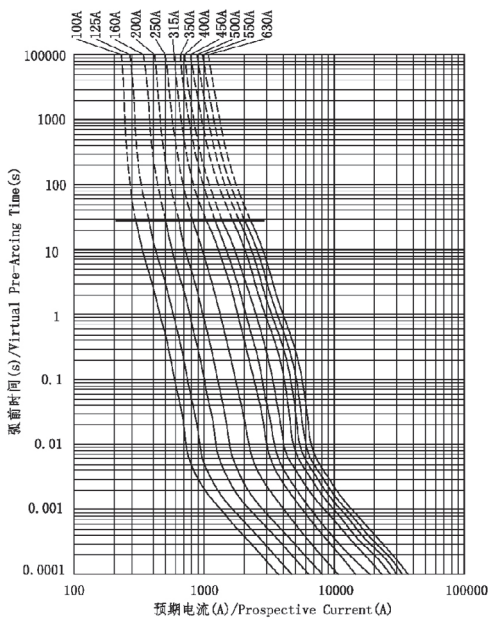

Note: The deviation range of the time current curve is  $\pm 10\%$  of the current

### Cut-off current characteristic curve

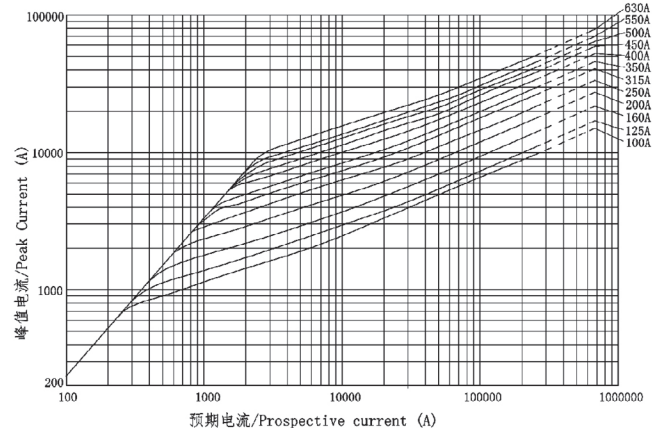

Note: The deviation range of the truncated current curve is  $\pm 10\%$  of the peak current

# DNESS2-S8Q

## Fuse for battery and battery system protection



Rated Voltage	DC 1500V
Rated Current	100A, 125A, 160A, 200A, 250A, 315A, 350A, 400A, 450A, 500, 550, 630A
Protection Category	aBat
Breaking Capacity	250kA
Reference Standard	IEC 60269-7

### Product parameter

Specification and model	size	Rated voltage V	Rated current A	Rated breaking capacity kA	forearc I <sup>2</sup> t kA <sup>2</sup> s	fusing I <sup>2</sup> t kA <sup>2</sup> s	In Dissipated power W
DNESS2-S8Q-100	2	DC 1500V	100	250kA	1.7	8.5	53
DNESS2-S8Q-125			125		3.6	17	63
DNESS2-S8Q-160			160		6	30	80
DNESS2-S8Q-200			200		12	52	90
DNESS2-S8Q-250			250		23	105	103
DNESS2-S8Q-315			315		40	210	106
DNESS2-S8Q-350			350		52	273	126
DNESS2-S8Q-400			400		80	309	133
DNESS2-S8Q-450			450		105	345	140
DNESS2-S8Q-500			500		154	493	153
DNESS2-S8Q-550			550		205	878	168
DNESS2-S8Q-630			630		273	1170	198

### Overall dimensions (mm)

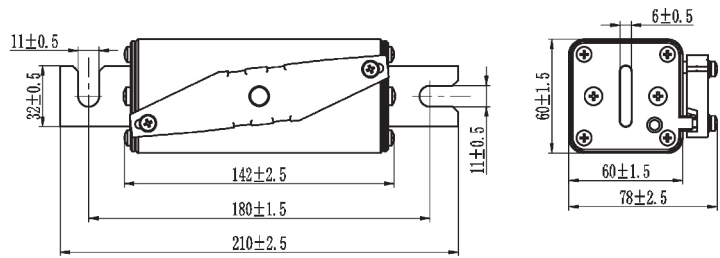

### Installation method

Bolt-on hook type (90° turn of touch blade)

### Time-current characteristic curve

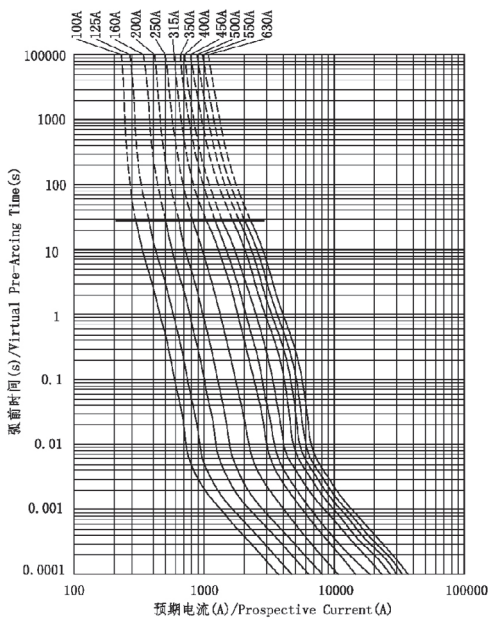

Note: The deviation range of the time current curve is  $\pm 10\%$  of the current

### Cut-off current characteristic curve

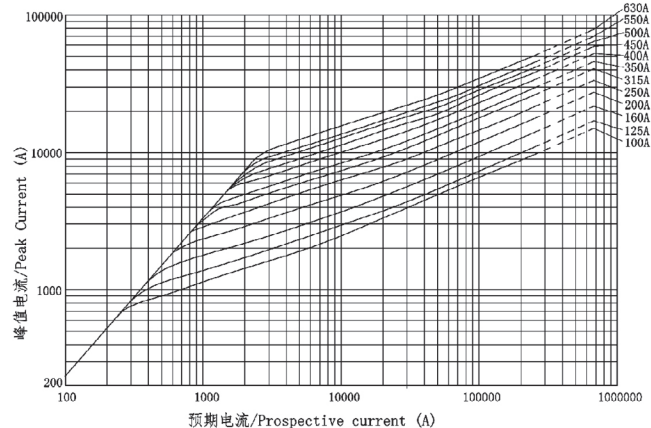

Note: The deviation range of the truncated current curve is  $\pm 10\%$  of the peak current

# DNESS2-S8R

## Fuse for battery and battery system protection



Rated Voltage	DC 1500V
Rated Current	100A, 125A, 160A, 200A, 250A, 315A, 350A, 400A, 450A, 500A, 550A, 630A
Protection Category	aBat
Breaking Capacity	250kA
Reference Standard	IEC 60269-7

### Product parameter

Specification and model	size	Rated voltage V	Rated current A	Rated breaking capacity kA	forearc I <sup>2</sup> t kA <sup>2</sup> s	fusing I <sup>2</sup> t kA <sup>2</sup> s	In Dissipated power W
DNESS2-S8R-100	2	DC 1500V	100	250kA	1.7	8.5	53
DNESS2-S8R-125			125		3.6	17	63
DNESS2-S8R-160			160		6	30	80
DNESS2-S8R-200			200		12	52	90
DNESS2-S8R-250			250		23	105	103
DNESS2-S8R-315			315		40	210	106
DNESS2-S8R-350			350		52	273	126
DNESS2-S8R-400			400		80	309	133
DNESS2-S8R-450			450		105	345	140
DNESS2-S8R-500			500		154	493	153
DNESS2-S8R-550			550		205	878	168
DNESS2-S8R-630			630		273	1170	198

### Overall dimensions (mm)

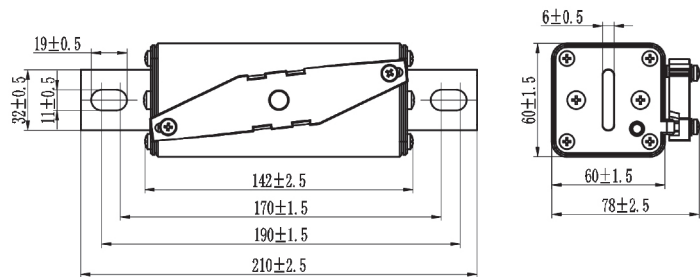

### Installation method

Bolted connection type

### Time-current characteristic curve

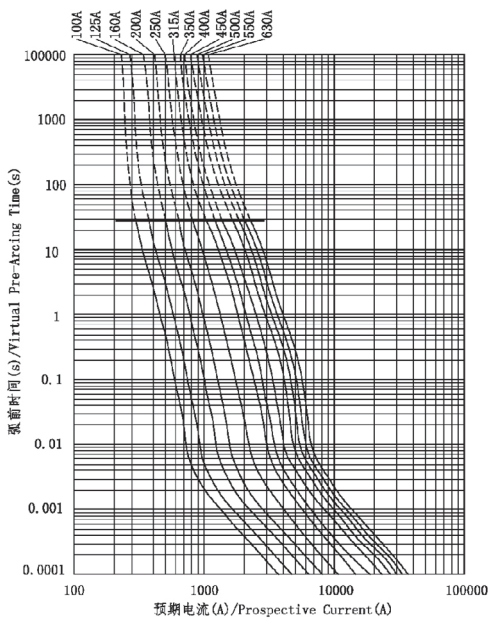

Note: The deviation range of the time current curve is  $\pm 10\%$  of the current

### Cut-off current characteristic curve

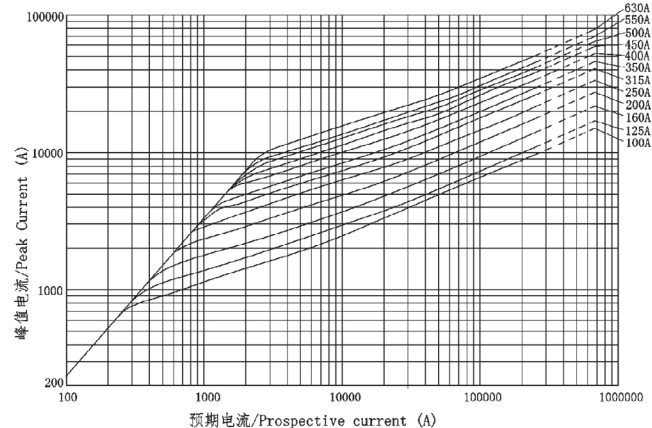

Note: The deviation range of the truncated current curve is  $\pm 10\%$  of the peak current

# DNESS3-S8□

## Fuse for battery and battery system protection



### Product Profile

DNESS3-S8□ Fuse for battery and battery system protection, suitable for battery system, with rated voltage of DC1500V and rated current of 100A~1000A, used for short circuit protection of battery and battery system.

### Model and meaning

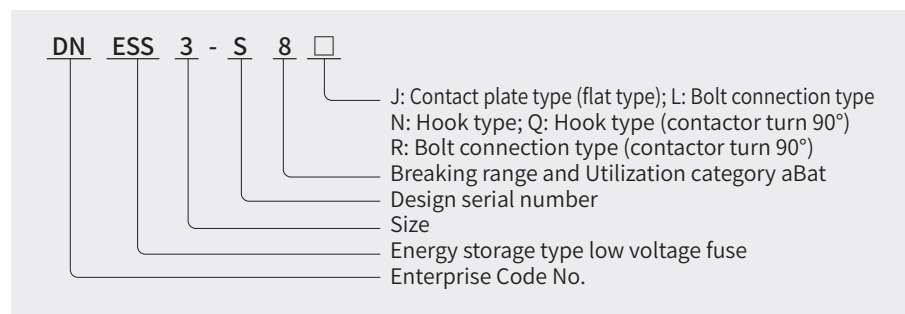

### Operational condition

- Working humidity range: At a maximum temperature of 40°C, the relative humidity does not exceed 50%. At a maximum temperature of 20°C, the relative humidity should not exceed 90%.
- Normal operating temperature range: -5°C to 40°C. Permissible temperature range: -40°C to 80°C.
- Altitude: no more than 2000m. When the altitude exceeds this value:
  - The temperature rise of the fuse increases by about 0.5k for every 100 meters above sea level.
  - For every 100 meters of elevation increase, the ambient temperature decreases by about 0.5 °C on average.
  - Under normal circumstances, fuses used in open environments can ignore the effect of altitude on rated current and still be selected in accordance with standard conditions.
  - For fuses used in closed environments, if the ambient air temperature of the box or the temperature inside the box does not decrease significantly with the elevation, it can still reach more than 40°C, it is necessary to reduce the rated current capacity. Fuse rated current selection formula:

$$I = I_n \times \left(1 - \frac{h-2000}{100} \times \frac{0.5}{100}\right)$$

# DNESS3-S8J

## Fuse for battery and battery system protection



Rated Voltage	DC 1500V
Rated Current	100A, 125A, 160A, 200A, 250A, 315A, 350A, 400A, 450A, 500A, 550A, 630A, 700A, 800A, 900A, 1000A
Protection Category	aBat
Breaking Capacity	250kA
Reference Standard	IEC 60269-7

### Product parameter

Specification and model	size	Rated voltage V	Rated current A	Rated breaking capacity kA	forearc I <sup>2</sup> t kA <sup>2</sup> s	fusing I <sup>2</sup> t kA <sup>2</sup> s	In Dissipated power W
DNESS3-S8J-100	3	DC 1500V	100	250kA	2	9	55
DNESS3-S8J-125			125		3.6	16	68
DNESS3-S8J-160			160		6	26	85
DNESS3-S8J-200			200		10	43	102
DNESS3-S8J-250			250		17	64	113
DNESS3-S8J-315			315		28	107	132
DNESS3-S8J-350			350		37.2	177	146
DNESS3-S8J-400			400		62	253	153
DNESS3-S8J-450			450		77.5	291	164
DNESS3-S8J-500			500		129	485	188
DNESS3-S8J-550			550		184	693	200
DNESS3-S8J-630			630		230	990	215
DNESS3-S8J-700			700		328	1238	267
DNESS3-S8J-800			800		468	1768	298
DNESS3-S8J-900			900		667	2072	319
DNESS3-S8J-1000	1000	846	2590	340			

### Overall dimensions (mm)

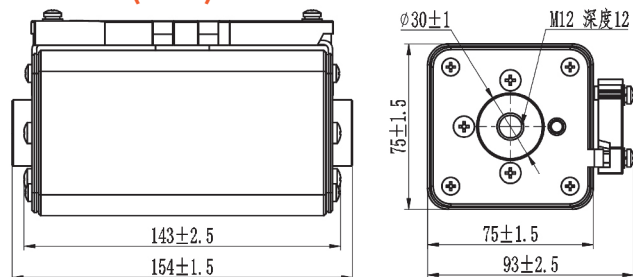

### Installation method

Bolted connection type

### Time-current characteristic curve

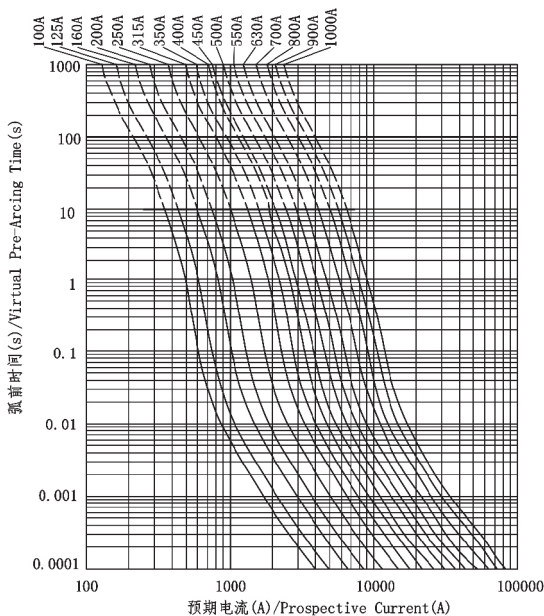

Note: The deviation range of the time current curve is  $\pm 10\%$  of the current

### Cut-off current characteristic curve

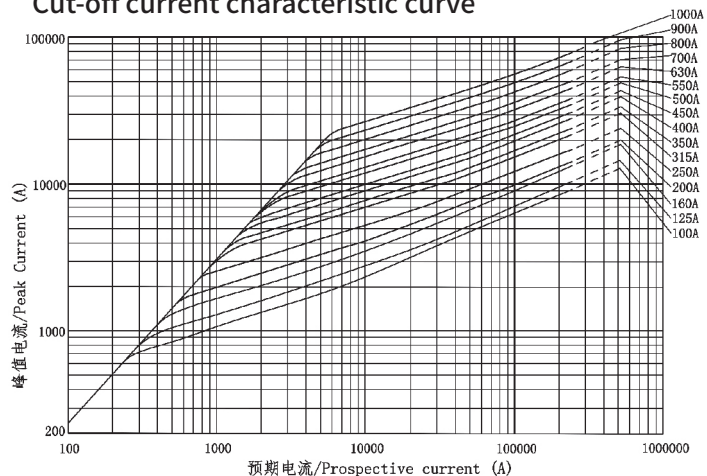

Note: The deviation range of the truncated current curve is  $\pm 10\%$  of the peak current



# DNESS3-S8L

## Fuse for battery and battery system protection



Rated Voltage	DC 1500V
Rated Current	100A, 125A, 160A, 200A, 250A, 315A, 350A, 400A, 450A, 500, 550, 630A, 700A, 800A, 900A, 1000A
Protection Category	aBat
Breaking Capacity	250kA
Reference Standard	IEC 60269-7

### Product parameter

Specification and model	size	Rated voltage V	Rated current A	Rated breaking capacity kA	forearc I <sup>2</sup> t kA <sup>2</sup> s	fusing I <sup>2</sup> t kA <sup>2</sup> s	In Dissipated power W
DNESS3-S8L-100	3	DC 1500V	100	250kA	2	9	55
DNESS3-S8L-125			125		3.6	16	68
DNESS3-S8L-160			160		6	26	85
DNESS3-S8L-200			200		10	43	102
DNESS3-S8L-250			250		17	64	113
DNESS3-S8L-315			315		28	107	132
DNESS3-S8L-350			350		37.2	177	146
DNESS3-S8L-400			400		62	253	153
DNESS3-S8L-450			450		77.5	291	164
DNESS3-S8L-500			500		129	485	188
DNESS3-S8L-550			550		184	693	200
DNESS3-S8L-630			630		230	990	215
DNESS3-S8L-700			700		328	1238	267
DNESS3-S8L-800			800		468	1768	298
DNESS3-S8L-900	900	667	2072	319			
DNESS3-S8L-1000	1000	846	2590	340			

### Overall dimensions (mm)

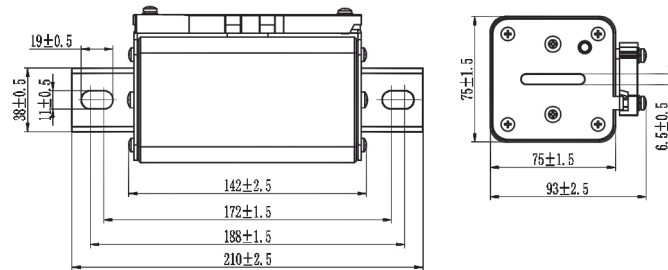

### Installation method

Bolted connection type

### Time-current characteristic curve

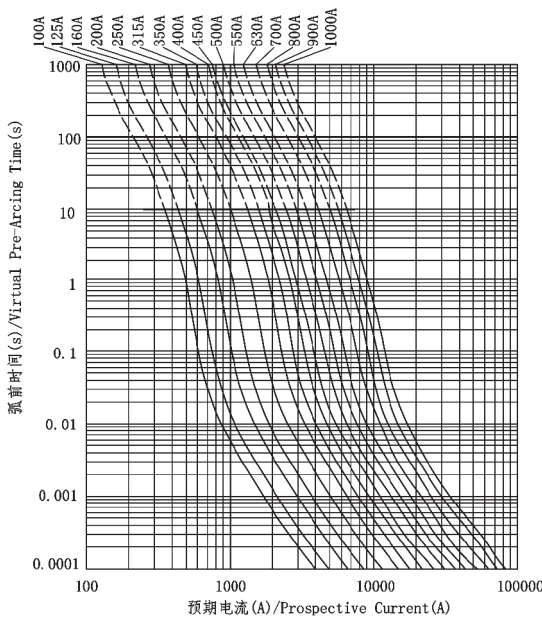

Note: The deviation range of the time current curve is  $\pm 10\%$  of the current

### Cut-off current characteristic curve

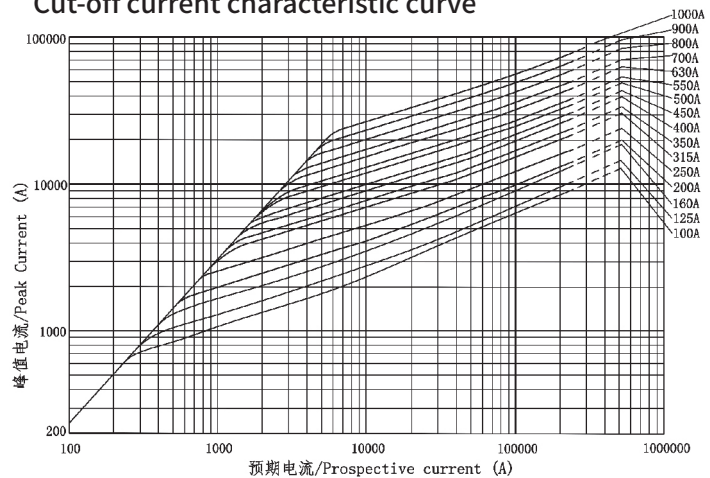

Note: The deviation range of the truncated current curve is  $\pm 10\%$  of the peak current

# DNESS3-S8N

## Fuse for battery and battery system protection



Rated Voltage	DC 1500V
Rated Current	100A, 125A, 160A, 200A, 250A, 315A, 350A, 400A, 450A, 500, 550, 630A, 700A, 800A, 900A, 1000A
Protection Category	aBat
Breaking Capacity	250kA
Reference Standard	IEC 60269-7

### Product parameter

Specification and model	size	Rated voltage V	Rated current A	Rated breaking capacity kA	forearc $I^2t$ kA <sup>2</sup> s	fusing $I^2t$ kA <sup>2</sup> s	In Dissipated power W
DNESS3-S8N-100	3	DC 1500V	100	250kA	2	9	55
DNESS3-S8N-125			125		3.6	16	68
DNESS3-S8N-160			160		6	26	85
DNESS3-S8N-200			200		10	43	102
DNESS3-S8N-250			250		17	64	113
DNESS3-S8N-315			315		28	107	132
DNESS3-S8N-350			350		37.2	177	146
DNESS3-S8N-400			400		62	253	153
DNESS3-S8N-450			450		77.5	291	164
DNESS3-S8N-500			500		129	485	188
DNESS3-S8N-550			550		184	693	200
DNESS3-S8N-630			630		230	990	215
DNESS3-S8N-700			700		328	1238	267
DNESS3-S8N-800			800		468	1768	298
DNESS3-S8N-900	900	667	2072	319			
DNESS3-S8N-1000	1000	846	2590	340			

### Overall dimensions (mm)

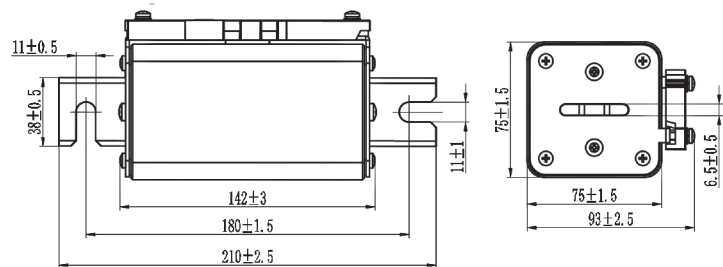

### Installation method

螺栓连接挂钩型

### Time-current characteristic curve

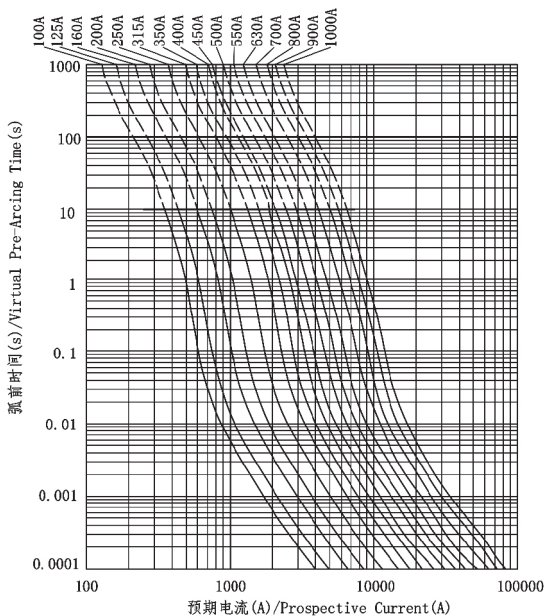

Note: The deviation range of the time current curve is  $\pm 10\%$  of the current

### Cut-off current characteristic curve

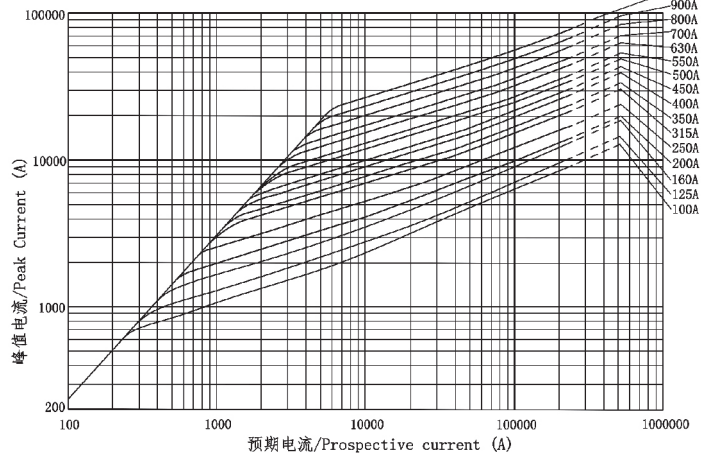

Note: The deviation range of the truncated current curve is  $\pm 10\%$  of the peak current

# DNESS3-S8Q

## Fuse for battery and battery system protection



Rated Voltage	DC 1500V
Rated Current	100A, 125A, 160A, 200A, 250A, 315A, 350A, 400A, 450A, 500, 550, 630A, 700A, 800A, 900A, 1000A
Protection Category	aBat
Breaking Capacity	250kA
Reference Standard	IEC 60269-7

### Product parameter

Specification and model	size	Rated voltage V	Rated current A	Rated breaking capacity kA	forearc I <sup>2</sup> t kA <sup>2</sup> s	fusing I <sup>2</sup> t kA <sup>2</sup> s	In Dissipated power W
DNESS3-S8Q-100	3	DC 1500V	100	250kA	2	9	55
DNESS3-S8Q-125			125		3.6	16	68
DNESS3-S8Q-160			160		6	26	85
DNESS3-S8Q-200			200		10	43	102
DNESS3-S8Q-250			250		17	64	113
DNESS3-S8Q-315			315		28	107	132
DNESS3-S8Q-350			350		37.2	177	146
DNESS3-S8Q-400			400		62	253	153
DNESS3-S8Q-450			450		77.5	291	164
DNESS3-S8Q-500			500		129	485	188
DNESS3-S8Q-550			550		184	693	200
DNESS3-S8Q-630			630		230	990	215
DNESS3-S8Q-700			700		328	1238	267
DNESS3-S8Q-800			800		468	1768	298
DNESS3-S8Q-900	900	667	2072	319			
DNESS3-S8Q-1000	1000	846	2590	340			

### Overall dimensions (mm)

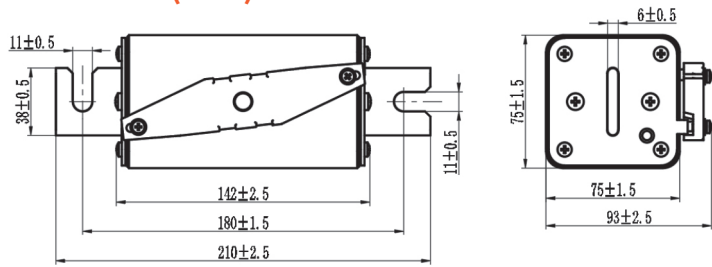

### Installation method

螺栓连接挂钩型

### Time-current characteristic curve

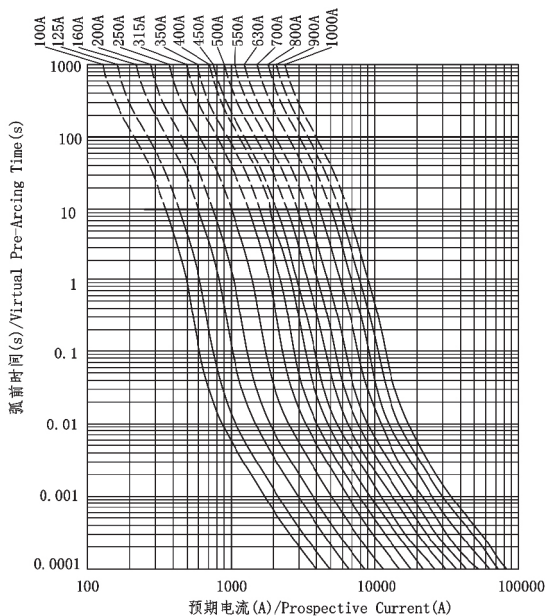

Note: The deviation range of the time current curve is  $\pm 10\%$  of the current

### Cut-off current characteristic curve

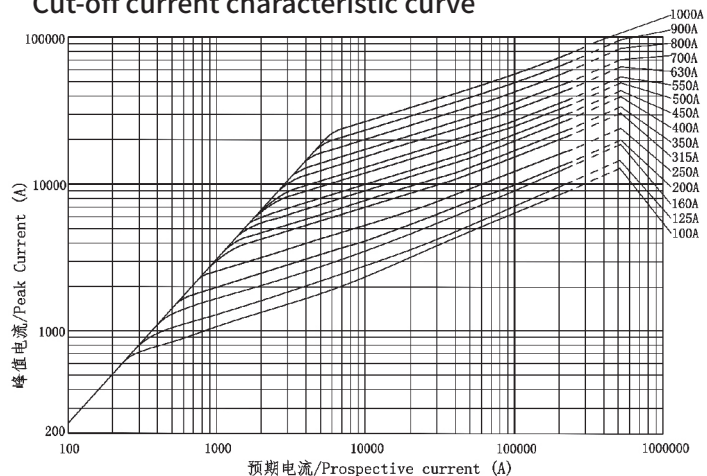

Note: The deviation range of the truncated current curve is  $\pm 10\%$  of the peak current

# DNESS3-S8R

## Fuse for battery and battery system protection



Rated Voltage	DC 1500V
Rated Current	100A, 125A, 160A, 200A, 250A, 315A, 350A, 400A, 450A, 500, 550, 630A, 700A, 800A, 900A, 1000A
Protection Category	aBat
Breaking Capacity	DC 250kA
Reference Standard	IEC 60269-7

### Product parameter

Specification and model	size	Rated voltage V	Rated current A	Rated breaking capacity kA	forearc $I^2t$ kA <sup>2</sup> s	fusing $I^2t$ kA <sup>2</sup> s	In Dissipated power W
DNESS3-S8R-100	3	DC 1500V	100	250kA	2	9	55
DNESS3-S8R-125			125		3.6	16	68
DNESS3-S8R-160			160		6	26	85
DNESS3-S8R-200			200		10	43	102
DNESS3-S8R-250			250		17	64	113
DNESS3-S8R-315			315		28	107	132
DNESS3-S8R-350			350		37.2	177	146
DNESS3-S8R-400			400		62	253	153
DNESS3-S8R-450			450		77.5	291	164
DNESS3-S8R-500			500		129	485	188
DNESS3-S8R-550			550		184	693	200
DNESS3-S8R-630			630		230	990	215
DNESS3-S8R-700			700		328	1238	267
DNESS3-S8R-800			800		468	1768	298
DNESS3-S8R-900	900	667	2072	319			
DNESS3-S8R-1000	1000	846	2590	340			

### Overall dimensions (mm)

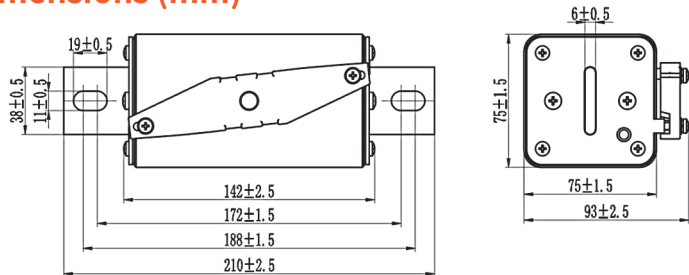

### Installation method

Bolted connection type

### Time-current characteristic curve

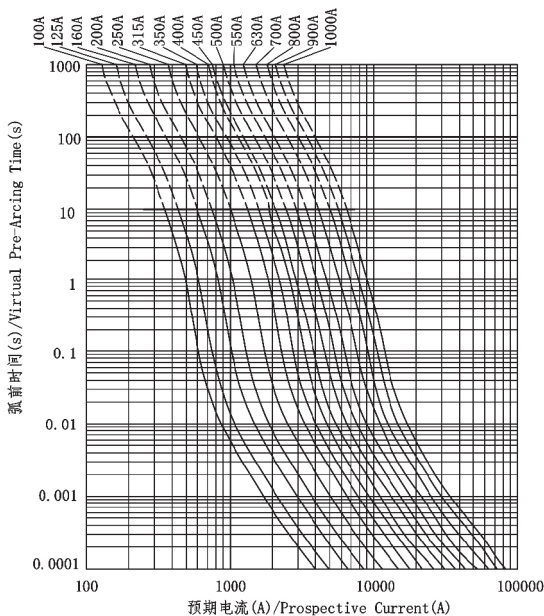

Note: The deviation range of the time current curve is  $\pm 10\%$  of the current

### Cut-off current characteristic curve

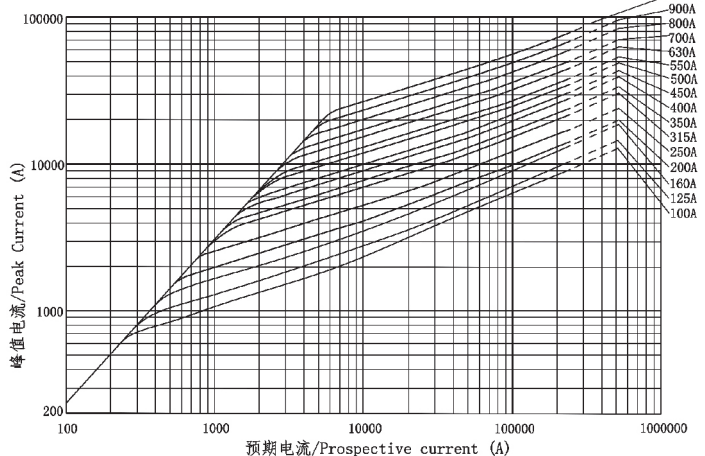

Note: The deviation range of the truncated current curve is  $\pm 10\%$  of the peak current

# DNESS5-S8J

## Fuse for battery and battery system protection



### Product Profile

DNESS5-S8J Battery and battery system protection fuse, suitable for battery system, rated voltage DC1500V,

### Model and meaning

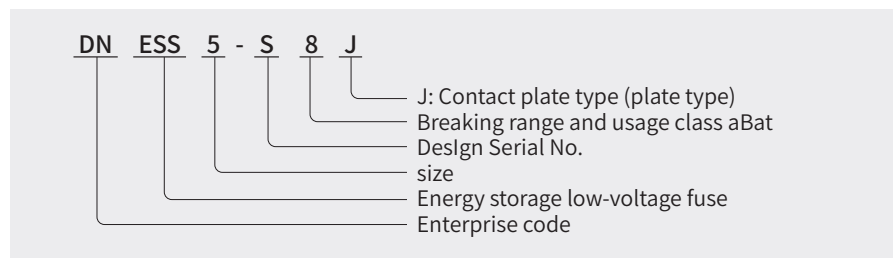

### Operational condition

1. Working humidity range: At a maximum temperature of 40°C, the relative humidity does not exceed 50%. At a maximum temperature of 20°C, the relative humidity should not exceed 90%.
2. Normal operating temperature range: -5 °C to 40°C. Permissible temperature range: -40°C to 80 °C.
3. Altitude: no more than 2000m. When the altitude exceeds this value:
  - 1) The temperature rise of the fuse increases by about 0.5k for every 100 meters above sea level.
  - 2) For every 100 meters of elevation increase, the ambient temperature decreases by about 0.5 °C on average.
  - 3) Under normal circumstances, fuses used in open environments can ignore the effect of altitude on rated current and still be selected in accordance with standard conditions.
  - 4) For fuses used in closed environments, if the ambient air temperature of the box or the temperature inside the box does not decrease significantly with the elevation, it can still reach more than 40°C, it is necessary to reduce the rated current capacity. Fuse rated current selection formula:

$$I = I_n \times \left(1 - \frac{h-2000}{100} \times \frac{0.5}{100}\right)$$

# DNESS5-S8J

## Fuse for battery and battery system protection



Rated Voltage	DC 1500V
Rated Current	450A, 500A, 550A, 630A, 700A, 800A, 900A, 1000A, 1100A, 1250A, 1350A, 1500A, 1600A, 1800A, 2000A
Protection Category	aBat
Breaking Capacity	250kA
Reference Standard	IEC 60269-7

### Product parameter

Specification and model	size	Rated voltage V	Rated current A	Rated breaking capacity kA	forearc I <sup>2</sup> t kA <sup>2</sup> s	fusing I <sup>2</sup> t kA <sup>2</sup> s	In Dissipated power W
DNESS5-S8J-450	5	DC 1500V	450	250kA	40	162	199
DNESS5-S8J-500			500		58	226	209
DNESS5-S8J-550			550		83	296	225
DNESS5-S8J-630			630		118	456	236
DNESS5-S8J-700			700		168	605	243
DNESS5-S8J-800			800		240	982	268
DNESS5-S8J-900			900		343	1305	281
DNESS5-S8J-1000			1000		490	1802	296
DNESS5-S8J-1100			1100		703	2604	308
DNESS5-S8J-1250			1250		1003	3502	332
DNESS5-S8J-1350			1350		1475	4829	350
DNESS5-S8J-1500			1500		2107	5861	360
DNESS5-S8J-1600			1600		3010	7840	369
DNESS5-S8J-1800			1800		4300	11200	393
DNESS5-S8J-2000	2000	5375	13975	421			

### Overall dimensions (mm)

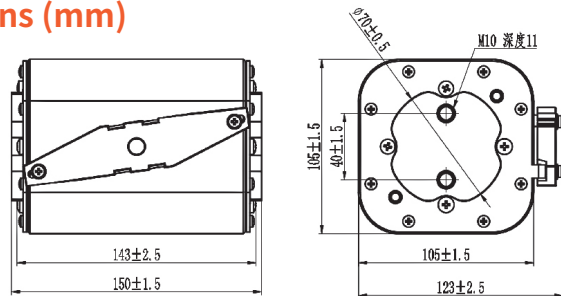

### Installation method

Bolted contact plate type (flat type)

### Time-current characteristic curve

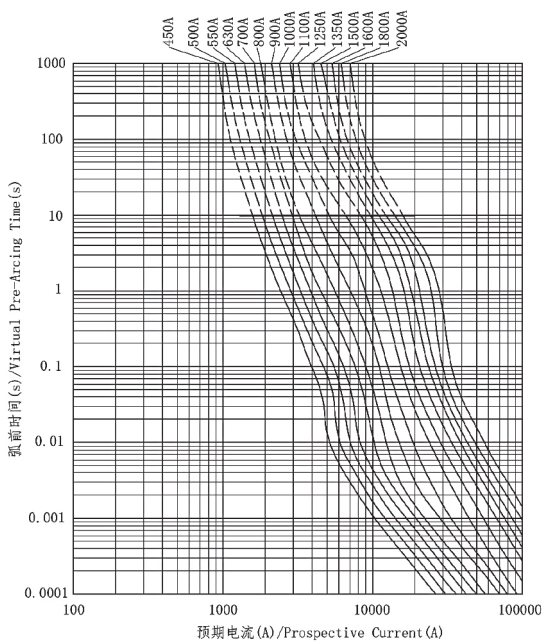

Note: The deviation range of the time current curve is  $\pm 10\%$  of the current

### Cut-off current characteristic curve

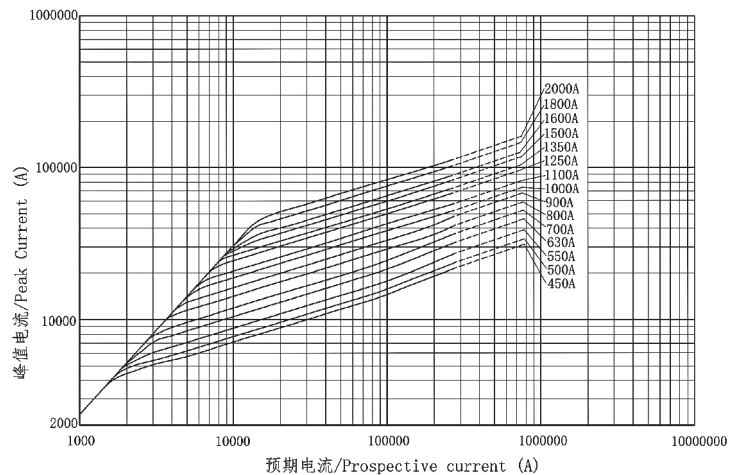

Note: The deviation range of the truncated current curve is  $\pm 10\%$  of the peak current

# DNESS8-S8J

## Fuse for battery and battery system protection



### Product Profile

DNESS8-S8J Battery and battery system protection fuse, suitable for battery system, rated voltage DC1500V,

The rated current is 1250A-3000A, which is used for short circuit protection of battery and battery system.

### Model and meaning

DN ESS 8 - S 8 J

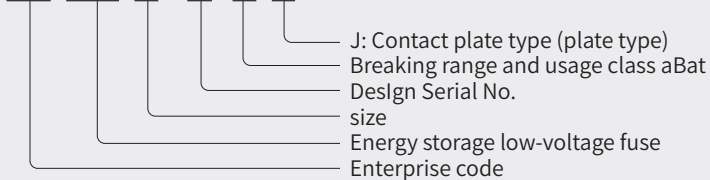

### Operational condition

1. Working humidity range: At a maximum temperature of 40°C, the relative humidity does not exceed 50%. At a maximum temperature of 20°C, the relative humidity should not exceed 90%.
2. Normal operating temperature range: -5°C to 40°C. Permissible temperature range: -40°C to 80°C.
3. Altitude: no more than 2000m. When the altitude exceeds this value:
  - 1) The temperature rise of the fuse increases by about 0.5k for every 100 meters above sea level.
  - 2) For every 100 meters of elevation increase, the ambient temperature decreases by about 0.5 °C on average.
  - 3) Under normal circumstances, fuses used in open environments can ignore the effect of altitude on rated current and still be selected in accordance with standard conditions.
  - 4) For fuses used in closed environments, if the ambient air temperature of the box or the temperature inside the box does not decrease significantly with the elevation, it can still reach more than 40°C, it is necessary to reduce the rated current capacity. Fuse rated current selection formula:

$$I = I_n \times \left(1 - \frac{h-2000}{100} \times \frac{0.5}{100}\right)$$

# DNESS8-S8J

## Fuse for battery and battery system protection



Rated Voltage	DC 1500V
Rated Current	1250A, 1400A, 1500A, 1600A, 1800A, 2000A, 2200A, 2400A, 2500A, 2600A, 2800A, 3000A
Protection Category	aBat
Breaking Capacity	250kA
Reference Standard	IEC 60269-7

### Product parameter

Specification and model	size	Rated voltage V	Rated current A	Rated breaking capacity kA	forearc I <sup>2</sup> t kA <sup>2</sup> s	fusing I <sup>2</sup> t kA <sup>2</sup> s	In Dissipated power W
DNESS8-S8J-1250	5	DC 1500V	1250	250kA	784	2698	506
DNESS8-S8J-1400			1400		998	3526	536
DNESS8-S8J-1500			1500		1260	4420	543
DNESS8-S8J-1600			1600		1605	5302	575
DNESS8-S8J-1800			1800		2205	6520	605
DNESS8-S8J-2000			2000		2960	8820	642
DNESS8-S8J-2200			2200		3809	10266	654
DNESS8-S8J-2400			2400		4700	11600	671
DNESS8-S8J-2500			2500		6158	12200	706
DNESS8-S8J-2600			2600		8797	14112	720
DNESS8-S8J-2800			2800		12568	20160	734
DNESS8-S8J-3000			3000		15750	28800	760

### Overall dimensions (mm)

#### Installation method

Bolted contact plate type (flat type)

#### Time-current characteristic curve

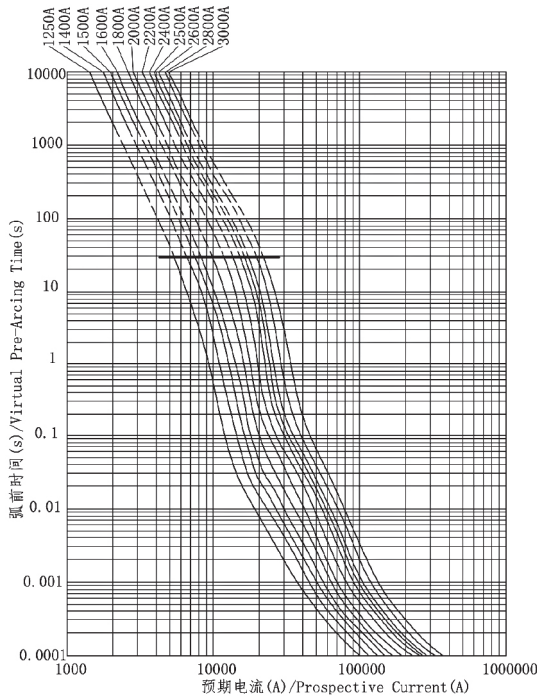

Note: The deviation range of the time current curve is  $\pm 10\%$  of the current

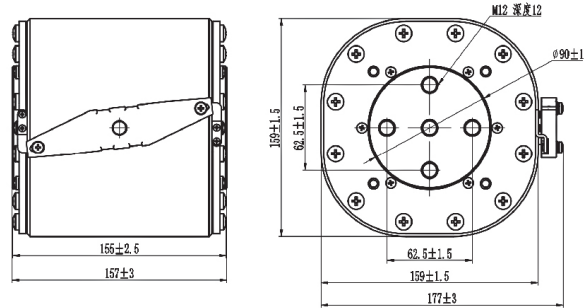

#### Cut-off current characteristic curve

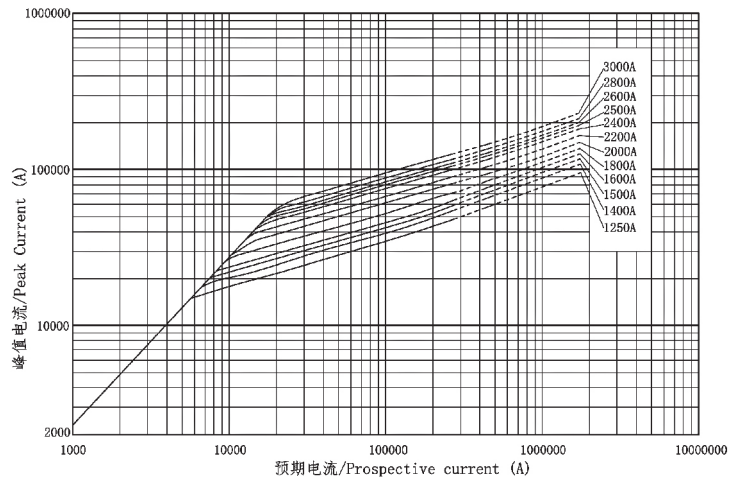

Note: The deviation range of the truncated current curve is  $\pm 10\%$  of the peak current